

(Portage 272 - Potter)

✓  
y 180  
No. 5434

✓  
a-57-1168  
No. 5433

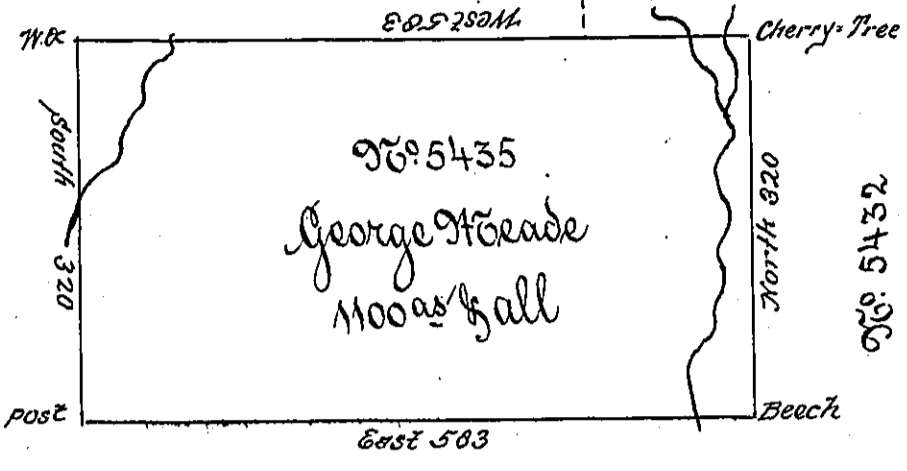

a 77-276

✓  
M-281

No. 5438

a 77 268

Situate on the waters of Sinnemahoning Creek in North<sup>W</sup> County containing 1100 acres and the usual allowance for roads surveyed May 17<sup>th</sup> 1794 for George Trade in pursuance of a warrant No. 5435 dated 3<sup>d</sup> March 1794

Daniel Bradhead Esq. S. G.

John Canan  
D. S.

IN TESTIMONY that the above is a copy of the original remaining on file in the Department of Internal Affairs of Pennsylvania, made conformably to an Act of Assembly approved the 16th day of February, 1833, I have hereunto set my Hand and caused the Seal of said Department to be affixed at Harrisburg, this first day of October 1901

*James W. Latta*  
Secretary of Internal Affairs.